

Plat of Survey

of
Lot 3 of Linden Fields, A Subdivision,
located in the Northwest 1/4 of the Southwest 1/4 of Section 13, Town 2
North, Range 15 East, City of Delavan, Walworth County, Wisconsin.

Surveyed for: **R & D Builders**
3116 Royal Oaks Drive
Elkhorn, Wisconsin. 53121

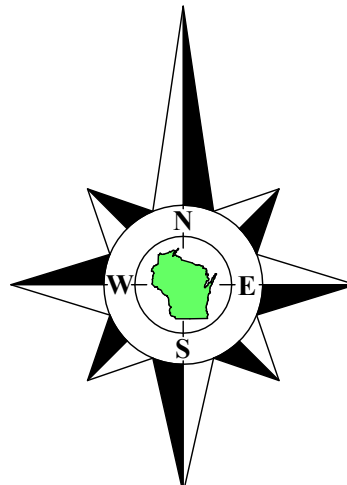

Bearings referenced to the South line of Whispering Pines Drive,
recorded as N88°40'22\"/>

Elevations are referenced a recorded elevation of 953.0 on
the rim of the Sanitary Sewer manhole at the intersection
of Linden Lane & Whispering Pines Drive.

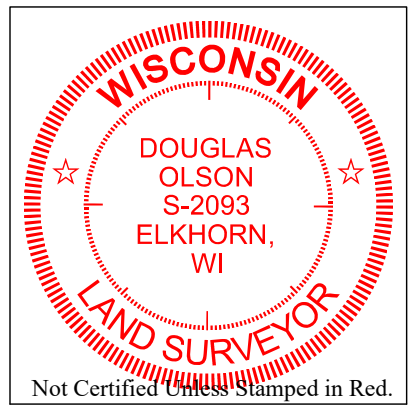

- Notes:**
- 1) This Plat of Survey is not certified unless signed and sealed in red ink.
 - 2) This survey is subject to Wisconsin lien laws. This Plat of Survey is the notice of intent to file lien. Lien waiver required.
 - 3) The Survey Date shown on this Plat of Survey is the completion date of the field work.

Copyright © 2023 by Olson Land Surveying, LLC.

All rights reserved. No part of this survey plat may be reproduced or transmitted in any form by any means - graphic, electronic, or mechanical, including photocopying, tracing, or information storage and retrieval systems - without permission in writing from Douglas G. Olson, Olson Land Surveying, LLC.

I hereby certify that I have surveyed the above described property in compliance with Chapter A-E 7 of the Wisconsin Administrative Code and that the map hereon is correct to the best of my professional knowledge and belief and shows the size and location of the property, its exterior boundaries, the location and dimensions of all visible structures thereon, boundary fences, apparent easements and roadways and visible encroachments, if any.
This survey is made for the exclusive use of the present owners of the property, and also those who purchase, mortgage or guarantee title thereto, within one year from the date hereof.

Douglas G. Olson
Wisconsin Professional Land Surveyor - 2093

Survey Date: August 5, 2023.
Revisions: No. 1 - 1' Interval Contours
with Spot Elevations

Scale in Feet
1" = 20'
0' 10' 20' 40' 60'

45 South Wisconsin Street | P.O. Box 322
Elkhorn, Wisconsin. 53121
Telephone: (262) 723-3434
Facsimile: (262) 723-8044
Email: doug@olsonsurveying.com
Website: www.olsonsurveying.com

OLSON

LAND SURVEYING, LLC

Rural | Residential | Commercial

Legend of Symbols & Abbreviations

Found Iron Pipe

Set Iron Pipe 1" dia.

Set Iron Pipe 4" dia.

Found Wood Stake

Recorded Information

Light Pole

Utility Box or Valve

Manhole

Asphalt Surface

Concrete Surface

North

South

East

West

in Degrees

in Minutes

in Feet

in Inches

Sheet 1 of 1 Sheets

Drawing Name:

Job Reference Number

2023.071

2023.071